

Existing 02:00pm

June 21st (BST)

Proposed 02:00pm

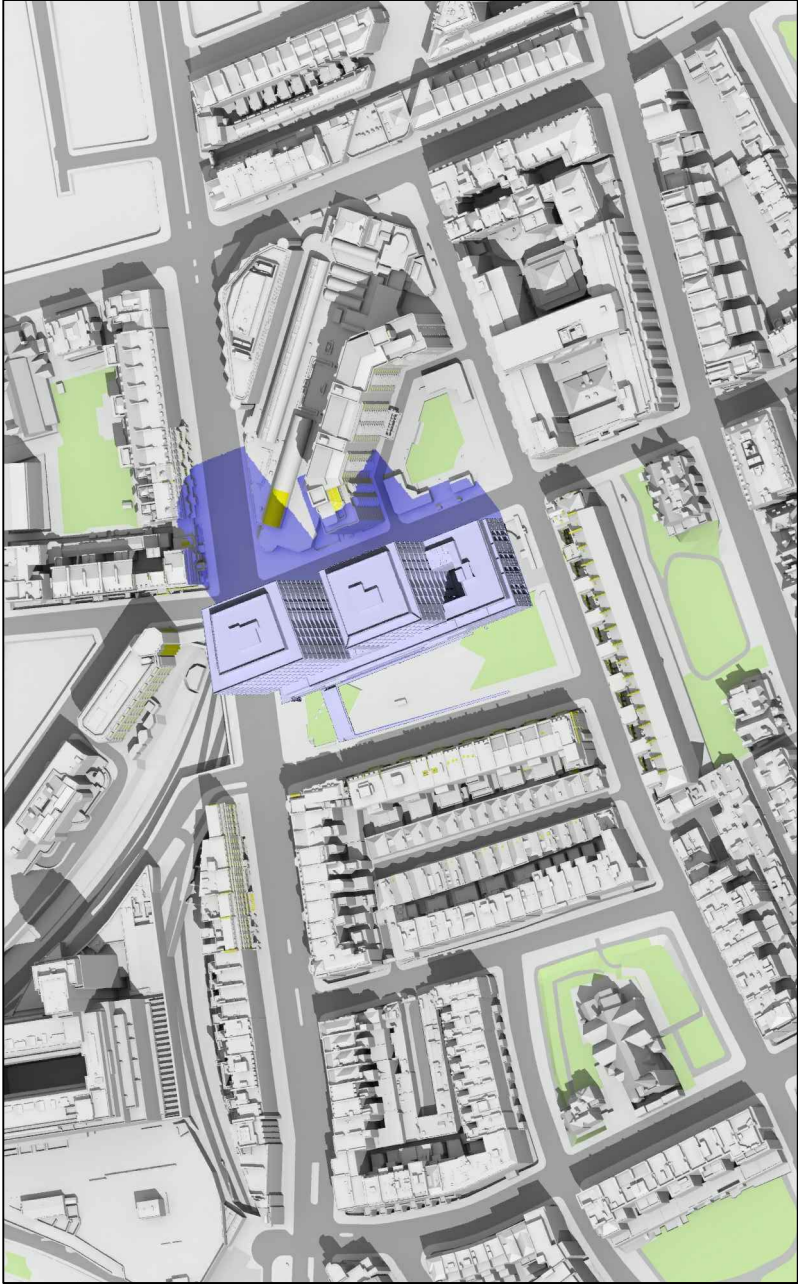

Existing 03:00pm

Proposed 03:00pm

Sources: Point2 Surveys:  
Site Photos  
Point Cloud Data  
  
Ordnance Survey:  
OS Map  
Zmap  
  
SimpsonHaugh and Partners:  
Received 03/12/18  
10061-Z0-G200-3-AL-Detailed Model.dwg  
10106-A-DRG-Z0-G100-4000(0-3).dwg's Elevations  
10106-A-DRG-Z0-G200-2000(00-31).dwg's Plans

Key:

Grey shadows are those caused by buildings which are not on the site under development.

Green shadows are those caused specifically by the existing buildings on the site.

Blue shadows are those caused specifically by the proposed development.

Project: Kensington Forum Hotel

Title: Transient Overshadowing

Drawn By: SA/CJ

Scale: NTS

Date: DEC 2018

Dwg No: **P813/ JUN1/05**

Point 2 Surveyors Ltd,  
3rd Floor  
17 Slingsby Place,  
London WC2E 9AB,  
0207 836 5828  
www.point2surveyors.com







Existing 04:00pm

June 21st (BST)



Proposed 04:00pm



Existing 05:00pm

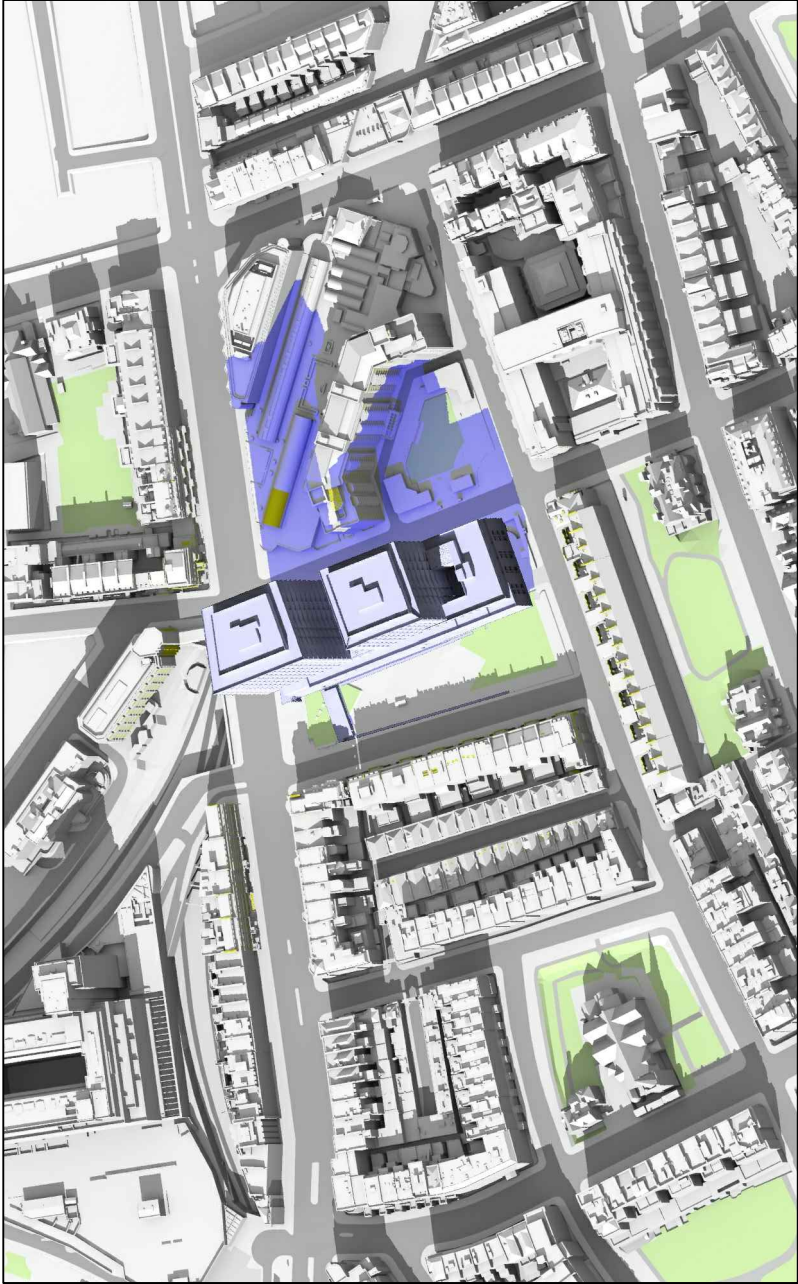

Proposed 05:00pm

Sources: Point2 Surveyors:  
Site Photos  
Point Cloud Data

Ordnance Survey:  
OS Map  
Zmap

SimpsonHaugh and Partners:  
Received 03/12/18  
10061-Z0-G200-3-AL-Detailed Model.dwg  
10106-A-DRG-Z0-G100-4000(0-3).dwg's Elevations  
10106-A-DRG-Z0-G200-2000(00-31).dwg's Plans

Key:

- Grey shadows are those caused by buildings which are not on the site under development.
- Green shadows are those caused specifically by the existing buildings on the site.
- Blue shadows are those caused specifically by the proposed development.

Project: Kensington Forum Hotel

Title: Transient Overshadowing

Drawn By: SA/CJ

Scale: NTS

Date: DEC 2018

Dwg No: **P813/ JUN1/06**

Point 2 Surveyors Ltd,  
3rd Floor  
17 Slingsby Place,  
London WC2E 9AB,  
0207 836 5828  
www.point2surveyors.com







Existing 06:00pm

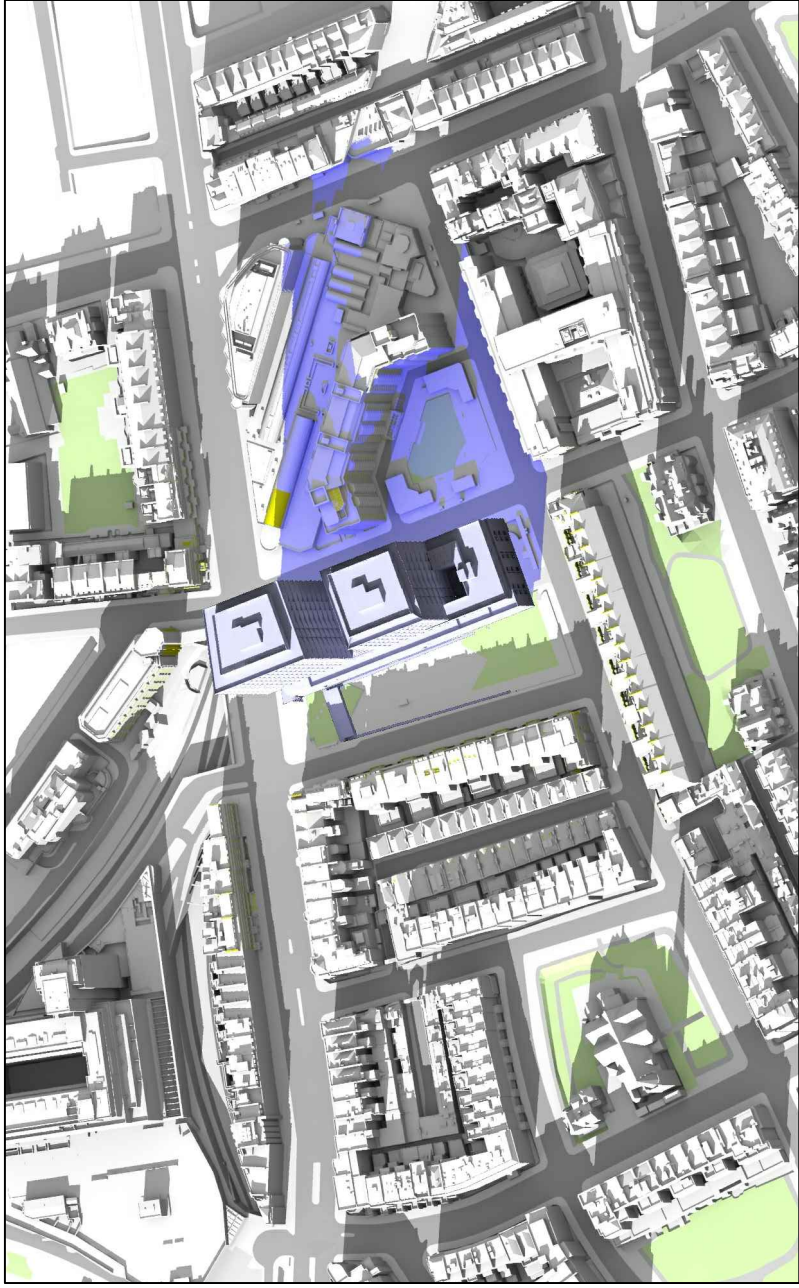

Proposed 06:00pm

June 21st (BST)

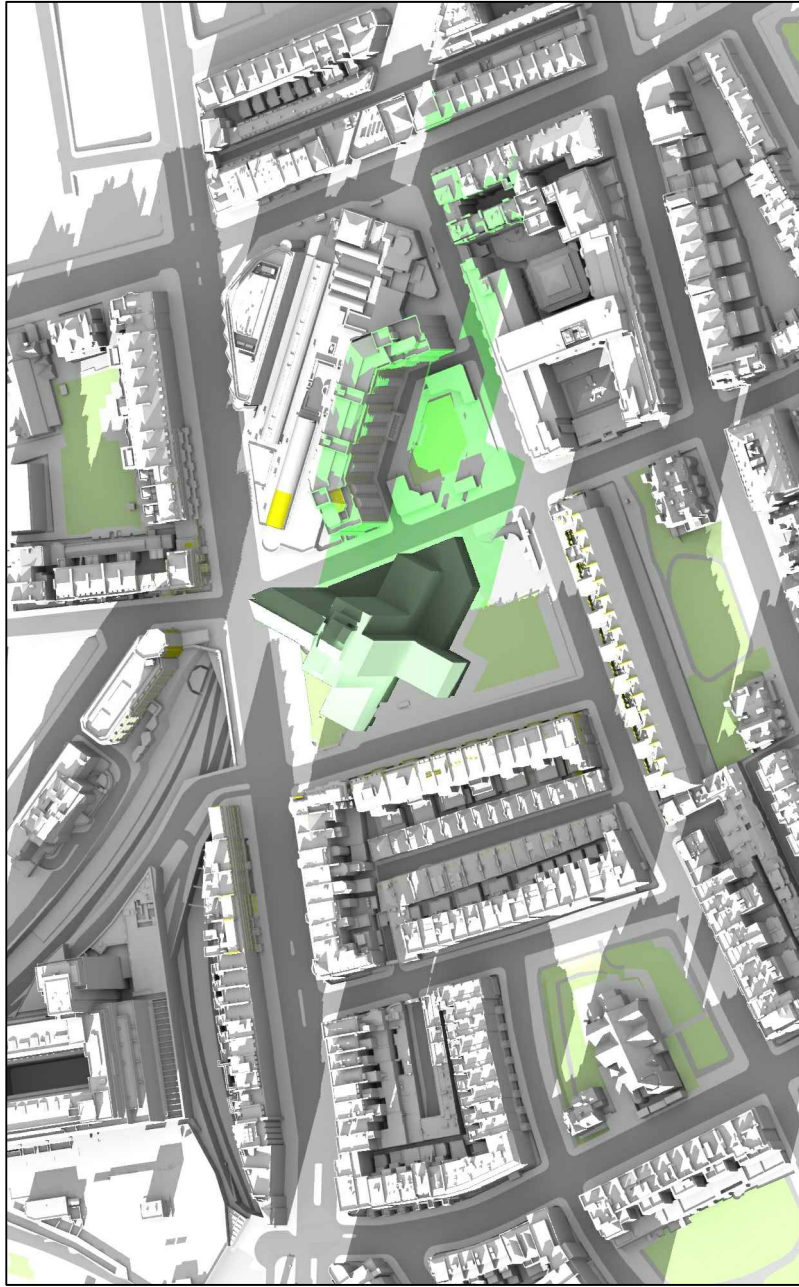

Existing 07:00pm



Proposed 07:00pm

Sources: Point2 Surveyors:  
Site Photos  
Point Cloud Data  
Ordnance Survey:  
OS Map  
Zmap

SimpsonHaugh and Partners:  
Received 03/12/18  
10061-Z0-G200-3-AL-Detailed Model.dwg  
10106-A-DRG-Z0-G100-4000(0-3).dwg's Elevations  
10106-A-DRG-Z0-G200-2000(00-31).dwg's Plans

Key:

- Grey shadows are those caused by buildings which are not on the site under development.
- Green shadows are those caused specifically by the existing buildings on the site.
- Blue shadows are those caused specifically by the proposed development.

Project: Kensington Forum Hotel

Title: Transient Overshadowing

Drawn By: SAC/J

Scale: NTS

Date: DEC 2018

Dwg No: **P813/ JUN1/07**

Point 2 Surveyors Ltd,  
3rd Floor  
17 Slingsby Place,  
London WC2E 9AB,  
0207 836 5828  
www.point2surveyors.com





Transient with Trees



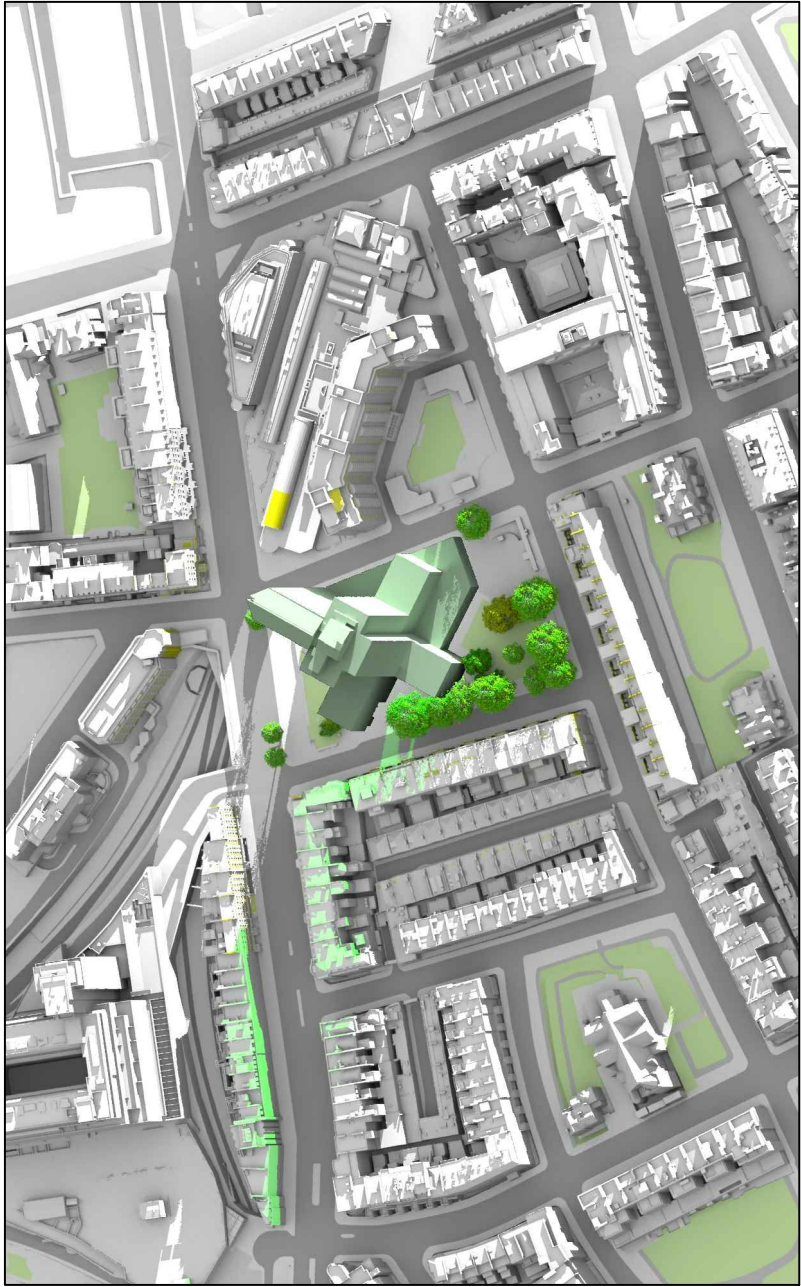

Existing 07:00am

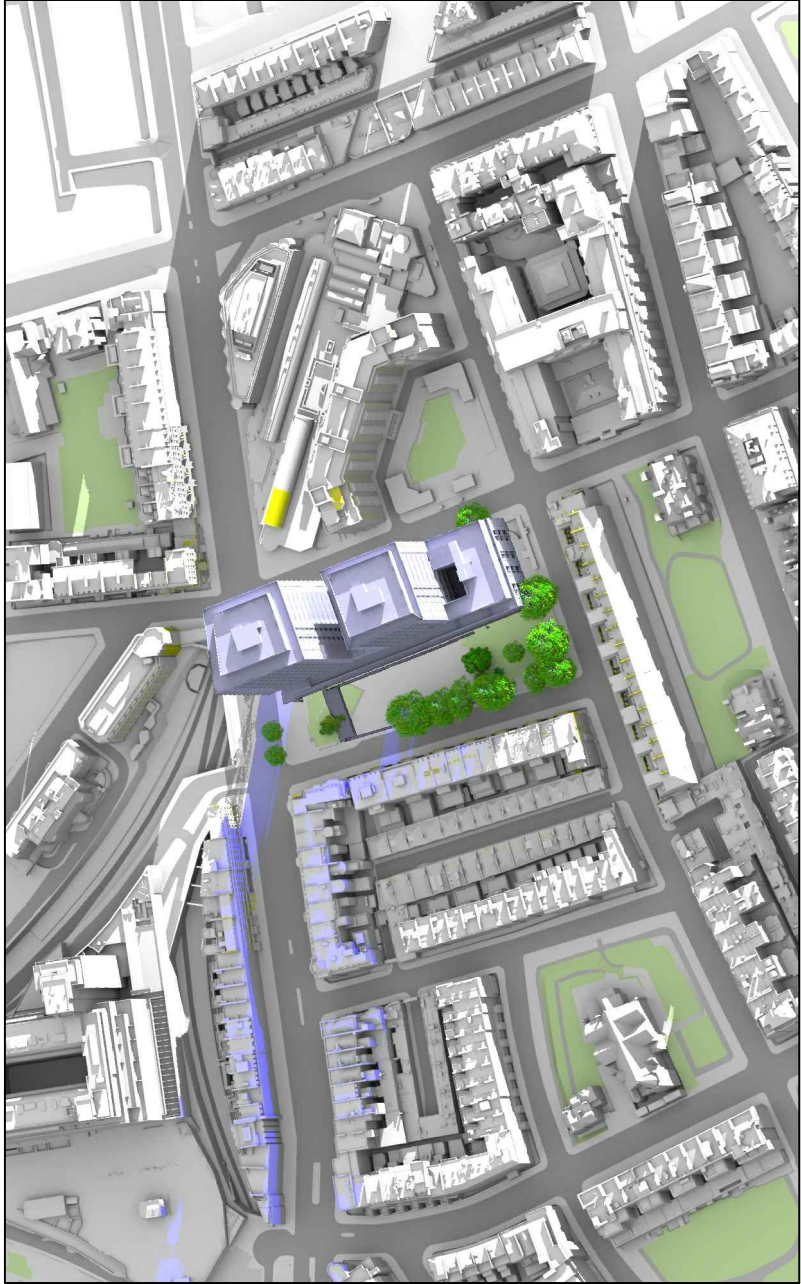

Proposed 07:00am

March 21st (GMT)

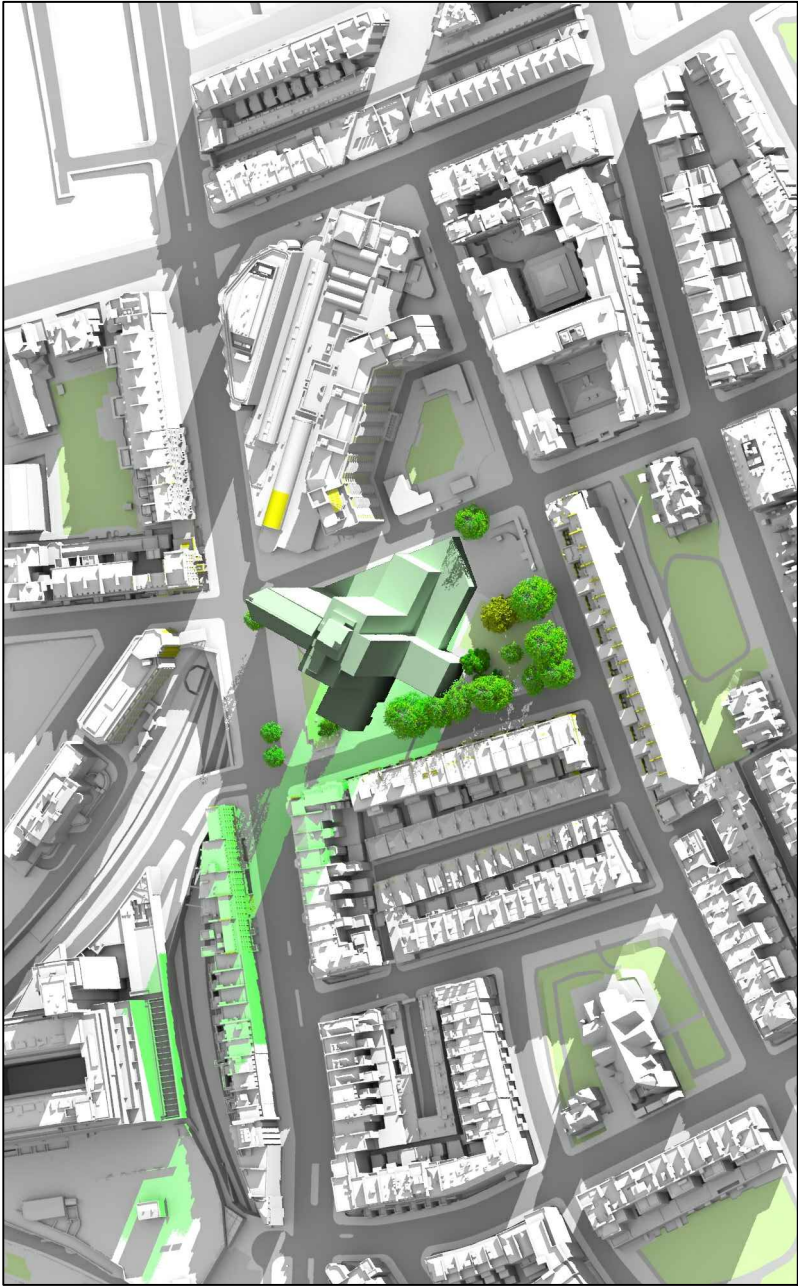

Existing 08:00am



Proposed 08:00am

Sources: Point2 Surveyors:  
Site Photos  
Point Cloud Data  
Ordnance Survey:  
OS Map  
Zmap

SimpsonHaugh and Partners:  
Received 03/12/18  
10061-Z0-G200-3-AL-Detailed Model.dwg  
10106-A-DRG-Z0-G100-4000(0-3).dwg's Elevations  
10106-A-DRG-Z0-G200-2000(00-31).dwg's Plans

Key:

- Grey shadows are those caused by buildings which are not on the site under development.
- Green shadows are those caused specifically by the existing buildings on the site.
- Blue shadows are those caused specifically by the proposed development.

Project: Kensington Forum Hotel

Title: Transient Overshadowing  
Tree Assessment

Drawn By: SA/CJ

Scale: NTS

Date: DEC 2018

Dwg No: **P813/ MAR1/01**

Point 2 Surveyors Ltd,  
3rd Floor  
17 Slingsby Place,  
London WC2E 9AB,  
0207 836 5828  
www.point2surveyors.com







Existing 09:00am



Proposed 09:00am

March 21st (GMT)



Existing 10:00am



Proposed 10:00am

Sources: Point2 Surveyors:  
Site Photos  
Point Cloud Data

Ordnance Survey:  
OS Map  
Zmap

SimpsonHaugh and Partners:  
Received 03/12/18  
10061-Z0-G200-3-AL-Detailed Model.dwg  
10106-A-DRG-Z0-G100-4000(0-3).dwg's Elevations  
10106-A-DRG-Z0-G200-2000(00-31).dwg's Plans

Key:

- Grey shadows are those caused by buildings which are not on the site under development.
- Green shadows are those caused specifically by the existing buildings on the site.
- Blue shadows are those caused specifically by the proposed development.

Project: Kensington Forum Hotel

Title: Transient Overshadowing  
Tree Assessment

Drawn By: SA/CJ

Scale: NTS

Date: DEC 2018

Dwg No: **P813/ MAR1/02**

Point 2 Surveyors Ltd,  
3rd Floor  
17 Slingby Place,  
London WC2E 9AB,  
0207 836 5828  
www.point2surveyors.com







Existing 11:00am



Proposed 11:00am

March 21st (GMT)



Existing 12:00pm



Proposed 12:00pm

Sources: Point2 Surveyors:  
Site Photos  
Point Cloud Data

Ordnance Survey:  
OS Map  
Zmap

SimpsonHaugh and Partners:  
Received 03/12/18  
10061-Z0-G200-3-AL-Detailed Model.dwg  
10106-A-DRG-Z0-G100-4000(0-3).dwg's Elevations  
10106-A-DRG-Z0-G200-2000(00-31).dwg's Plans

Key:

- Grey shadows are those caused by buildings which are not on the site under development.
- Green shadows are those caused specifically by the existing buildings on the site.
- Blue shadows are those caused specifically by the proposed development.

Project: Kensington Forum Hotel

Title: Transient Overshadowing  
Tree Assessment

Drawn By: SAC/J

Scale: NTS

Date: DEC 2018

Dwg No: **P813/ MAR1/03**

Point 2 Surveyors Ltd,  
3rd Floor  
17 Slingby Place,  
London WC2E 9AB,  
0207 836 5828  
www.point2surveyors.com

